

Item	Split Core Current Transformer	Model	SCT-T16
------	--------------------------------	-------	---------

Dimension (Unit: in)

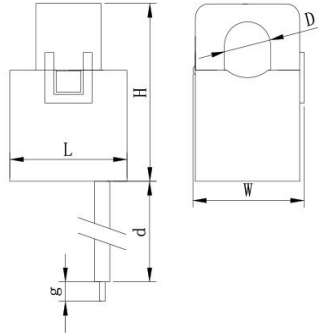

Outline Size			Window Size	Intallation Size	
L	W	H	D	d	g
1.22	1.25	1.81	0.62	39.37	0.23

Electrical Diagram Parameters



Current Range	≤120A
Output	0.333V
Accuracy	1.0
Frequency	50/60HZ
Insulation Strength	3KV

Performance Curve Specification

SCT-T16 Performance Curve (Burden 10Ω) :

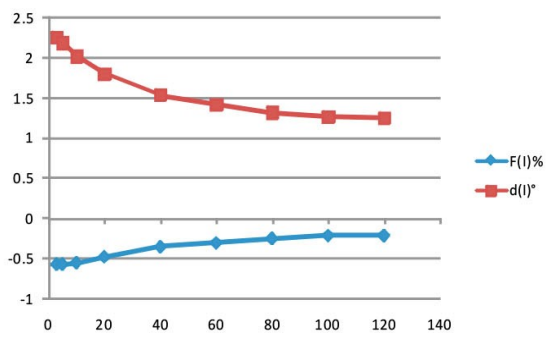

Leads: 1015# 24AWG
 Operating Temperature: -20°C to +55°C
 Storage Temperature: -40°C to +70°C
 Features: Split core design, the split core design permits non-contact current measurements through magnetic field induction without requiring that the primary wire be taken offline and disconnected for CT installation. This method permits a safer, easy and portable current measurement